

## TWO PART DISPENSER

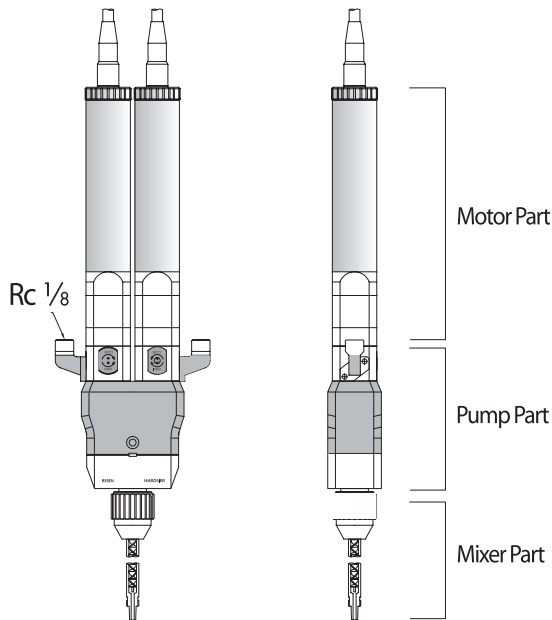

There are many different model of Mixer up to hardening condition of liquid.

### FEATURES

- **Consistent and long dosing by special Progressive cavity pump structure.**  
Precision and stable dosing is possible with higher pump efficiency and reproducibility than existing Positive displacement pump.
- **Simple adjustment of mixing ratio and dosing volume.**  
Dosing volume can be controlled simply and quickly by control of Rotor's rotating and velocity.
- **Wide range of dosing regardless of difference of viscosity and mixing ratio.**  
Special pump structure can be used for low and high viscosity regardless of material and external environment.
- **Clean dosing without leaking at the end of the nozzle.**  
No leaking (No ball-up effect) due to Suckback by control normal & counter rotation.
- **Economical dosing by easy maintenance and eco-friendly (No need to clean).**  
Saving cleaning expences and maintenance clean environment by exchanging mixer instead of using harmful cleaning liquid.

## CONTROLLER

### OUTSIDE VIEW

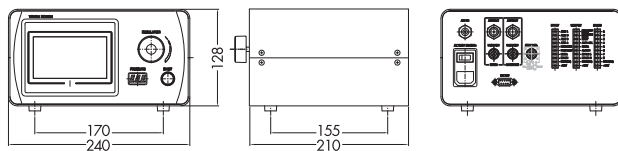

### FEATURES

- Precise & various dosing by exclusive Software for 2-component type.
- Color Touch Screen of user-friendly interface & high data recognition.
- Memory function (16CH) for complicated and various dosing.
- External Interface function for continuously various dosing.
- Easy controller by intuitively setting and data change.

### DISPENSER SPECIFICATIONS

ITEM	PDP-015	PDP-050	PDP-150	PDP-500	PDP-1500
Material Inlet Port	RC 1/8	RC1/8	RC1/8	RC1/8	RC1/4
Input Pressure	0-6Kgf/cm <sup>2</sup>				
Accuracy of Dosing	±1%				
Viscosity (cps)	1-200,000 cps				
Min. Dosing Volum	0.0003 ml	0.001 ml	0.003 ml	0.01 ml	0.03 ml
Mixture Ratio	1 : 1 ~ 10 : 1				
Max. Dosing Pressure	20Kgf/cm <sup>2</sup>	15Kgf/cm <sup>2</sup>	15Kgf/cm <sup>2</sup>	15Kgf/cm <sup>2</sup>	15Kgf/cm <sup>2</sup>
Wetting Part Material	SUS303F / UHMW PE / Super Fluoro Rubber				
Material Output Pot	Bayonet B type (STD) / Bayonet A type / Bell-Mouth type				

### CONTROLLER SPECIFICATIONS

Power In/Out	"AC220, 50/60 Hz, / DC24V"	Input Signal	"Contact Input or NPN open Collector Tr"
Consumption	200VA	Output Signal	NPN open Collector
Operating Mode	Time Steady Auto Cycle Ratio	Display	"Contact Input or NPN open Collector Tr"
Memory	16ch	Air In/Out	"Ø6 Air Hose / Auto Joiner"
Interface	RS232, D-SUB 9 PIN	Press. Regulator	0-7 Kgf/cm <sup>2</sup>
		Weight	3.6 kg